

## RIVET RACK INSTALLATION INSTRUCTIONS

### Basic Components - Single Unit with Double Rivet Beams with Support Ties Shown ↓

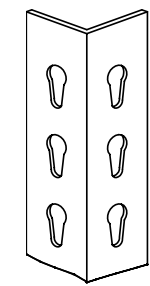

Angle Post

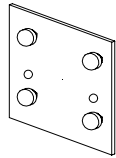

Tie Plate  
Joins Angle Posts

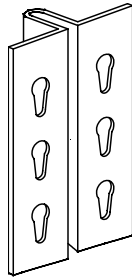

Tee Post

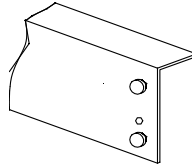

Double  
Rivet Beam

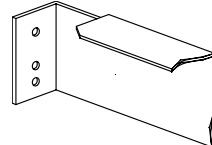

Support  
Tie Beam

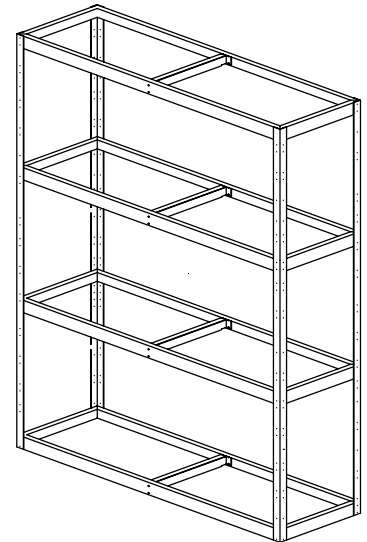

Individual (stand-alone units) use **Angle Posts** on all 4 corners. Multiple units in a row use **Angle Posts** at row ends and **Tee Posts** (or double Angle Posts connected with 2 Tie Plates) at the intermediate upright locations. During installation, be sure the components are oriented as shown above and use a mallet to fully seat rivets in the keyhole slots.

### Check component counts and read Instructions fully *before* starting!

1. Construct a row end upright assembly by laying two Angle Posts on the floor with the keyhole slots pointing in the same direction. Install 2 side (shorter) Double Rivet Beams at the top and bottom of both posts.
2. For Individual Units, repeat Step #1 to construct a second row end upright assembly. For Multiple Units in a row, repeat Step #1 using Tee Posts or Double Angle Posts (connected with 2 Tie Plates) to construct an intermediate upright assembly with Double Rivet beams on both sides of the upright assembly.
3. Lay the two upright assemblies on edge facing each other and install the rear (longer) Double Rivet Beams at the top and bottom of both Upright Assemblies. Turn the unit over and repeat to install the front (longer) Double Rivet Beams.
4. Stand the assembled unit upright and check to see that all rivets are fully seated in the keyhole slots. For multiple units in a row, assemble all the additional intermediate uprights as in Step #2. Stand an upright assembly vertically and install the front and rear Double Rivet Beams at the top & bottom of the upright assembly and the previously assembled unit. Continue with the intermediate upright assemblies to the end of the row. Repeat Step #1 to construct a row end upright assembly to finish the row and install the front and rear Double Rivet Beams at the top and bottom of the row end upright assembly and the assembled row.
5. Install the side, front & rear Double Rivet Beams at all required locations.
6. Install only **ONE** Support Tie in **center** of each shelf with the screws and nuts provided. Disregard all other holes in the Double Rivet Beams. Tighten all connections securely.
7. Install all shelf deck surfaces (usually 7/16" OSB, 5/8" particleboard or welded wire panels). **Note:** Deck surfaces are cut to the nominal shelf size. **Note:** Very closely spaced shelves may require the installation of a lower shelf deck surface *before* the next higher level of Double Rivet Beams is installed.